



WILTCHER'S
STEIGENBERGER

BRUSSELS



Make your mark
on success



AT THE CENTRE OF CITY LIFE

The Steigenberger Wiltcher's is more than a luxury hotel. It's a unique experience in Brussels, in the great tradition of Europe's grand hotels. It embodies all the elegance of Avenue Louise, the city's golden shopping mile. A short step from the historic centre, it offers function space unequalled in Brussels with a total of 1100 m² for meetings, banquets and conventions.

ROOMS AND SUITES

The 225 rooms and 42 suites, luxuriously decorated in a contemporary style, are among the most spacious in Brussels. The Royal Suite boasts a private dining room that's ideal for small meetings.

FOOD AND DRINK

Steigenberger's hallmark is flavoursome cuisine combined with discreetly efficient service. Whether in the intimate setting of the restaurant, in the bar, for a private cocktail party on the terrace or a big reception in the ballroom, we make it our duty to give you the best.



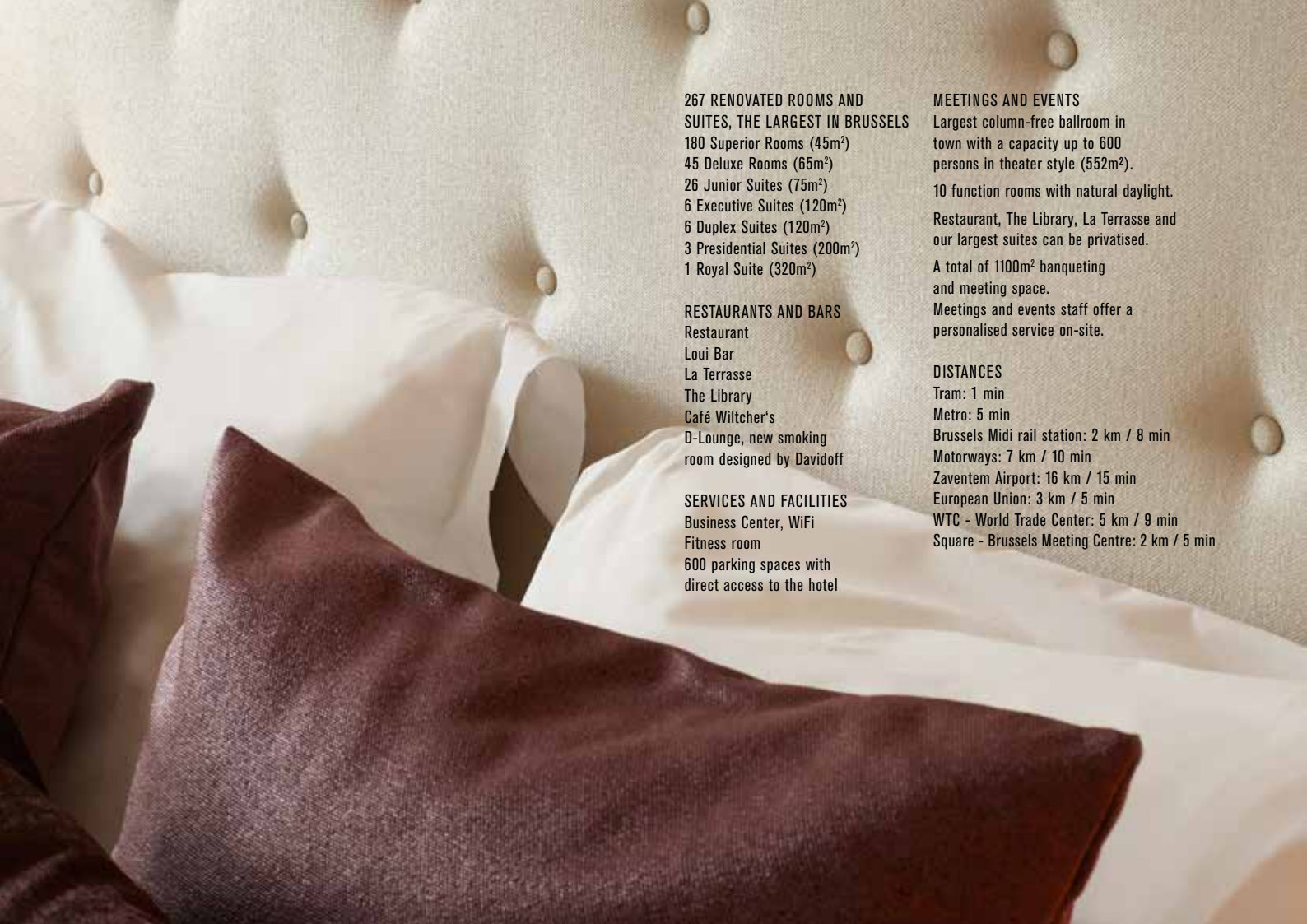

267 RENOVATED ROOMS AND SUITES, THE LARGEST IN BRUSSELS

180 Superior Rooms (45m²)
45 Deluxe Rooms (65m²)
26 Junior Suites (75m²)
6 Executive Suites (120m²)
6 Duplex Suites (120m²)
3 Presidential Suites (200m²)
1 Royal Suite (320m²)

RESTAURANTS AND BARS

Restaurant
Loui Bar
La Terrasse
The Library
Café Wiltcher's
D-Lounge, new smoking room designed by Davidoff

SERVICES AND FACILITIES

Business Center, WiFi
Fitness room
600 parking spaces with direct access to the hotel

MEETINGS AND EVENTS

Largest column-free ballroom in town with a capacity up to 600 persons in theater style (552m²).

10 function rooms with natural daylight.

Restaurant, The Library, La Terrasse and our largest suites can be privatised.

A total of 1100m² banqueting and meeting space.

Meetings and events staff offer a personalised service on-site.

DISTANCES

Tram: 1 min

Metro: 5 min

Brussels Midi rail station: 2 km / 8 min

Motorways: 7 km / 10 min

Zaventem Airport: 16 km / 15 min

European Union: 3 km / 5 min

WTC - World Trade Center: 5 km / 9 min

Square - Brussels Meeting Centre: 2 km / 5 min



MEETING ROOMS	DAYLIGHT	AIR-CONDITIONING	FLOOR	Nº	MEASUREMENTS	CELLING HT	THEATRE	CLASSROOM	U-SHAPE	CABARET	BOARDROOM	H-SQUARE	ROUND TABLE (12 PER TABLE) NO DANCE FLOOR	ROUND TABLE- (12 PER TABLE) DANCE FLOOR	COCKTAIL
Antichambre	•	•	1	19	3,7m*5,2m	3m	***	***	***	***	***	***	10	***	***
Ballroom		•	0	552	15m*36,8m	3,7m	600	350	96	301	***	150	528	480	600
Ballroom A		•	0	147	15m*9,8m	3,7m	150	72	36	63	***	50	132	84	150
Ballroom B		•	0	258	15m*17,2m	3,7m	250	150	48	119	***	80	240	192	250
Ballroom C		•	0	147	15m*9,8m	3,7m	150	72	36	63	***	50	132	84	150
Bellevue	•	•	1	72	9,8m*7,35m	2,75m	60	40	27	35	27	30	60	***	75
Bellevue A	•	•	1	36	4,9m*7,35m	2,75m	25	18	15	14	12	18	24	***	35
Bellevue B	•	•	1	36	4,9m*7,35m	2,75m	25	18	15	14	12	18	24	***	35
Belvedere	•	•	1	72	9,8m*7,35m	2,75m	60	40	27	35	27	30	60	***	75
Belvedere A	•	•	1	36	4,9m*7,35m	2,75m	25	18	15	14	12	18	24	***	35
Belvedere B	•	•	1	36	4,9m*7,35m	2,75m	25	18	15	14	12	18	24	***	35
Boudoir	•	•	1	16	3,2m*5m	3m	***	***	***	***	***	***	8	***	***
Empire	•	•	1	65	7,82m*8,25m	3m	50	24	20	35	22	24	48	***	60
Hermitage	•	•	1	37	5m*7,35m	2,75m	***	***	***	***	14	***	***	***	***
Honneur	•	•	1	53	6,8m*7,8m	3m	30	18	15	21	20	20	36	***	50
Foyer		•	0	95	7,8m*12,14m	3m	80	30	20	35	36	30	96	72	130
The Library	•	•	0	314	16,10m*19,5m	2,89m	***	***	***	***	***	***	Existing set up 110	***	300
Private dining	•	•	0	21	5,9*3,52m	2,89m	***	***	***	***	12	***	***	***	***
Terrasse	•		0	126	5,2*24,15m	***	***	***	***	***	***	***	Existing set up 56	***	130
Café Wiltcher's (mezzanine)	•	•	0	67	7,3*9,23m	3,1m	50	***	***	***	20	***	Existing set up 44	***	60
Café Wiltcher's (main level)	•	•	0	54	5,88*9,1m	3,3m	30	***	***	***	***	***	Existing set up 29	***	50
Café Wiltcher's (total)	•	•	0	121	13,28*9,1m	3,1m	***	***	***	***	***	***	Existing set up 73	***	150

Our spacious suites can also be privatized for exclusive events

FLOOR PLAN & CAPACITIES

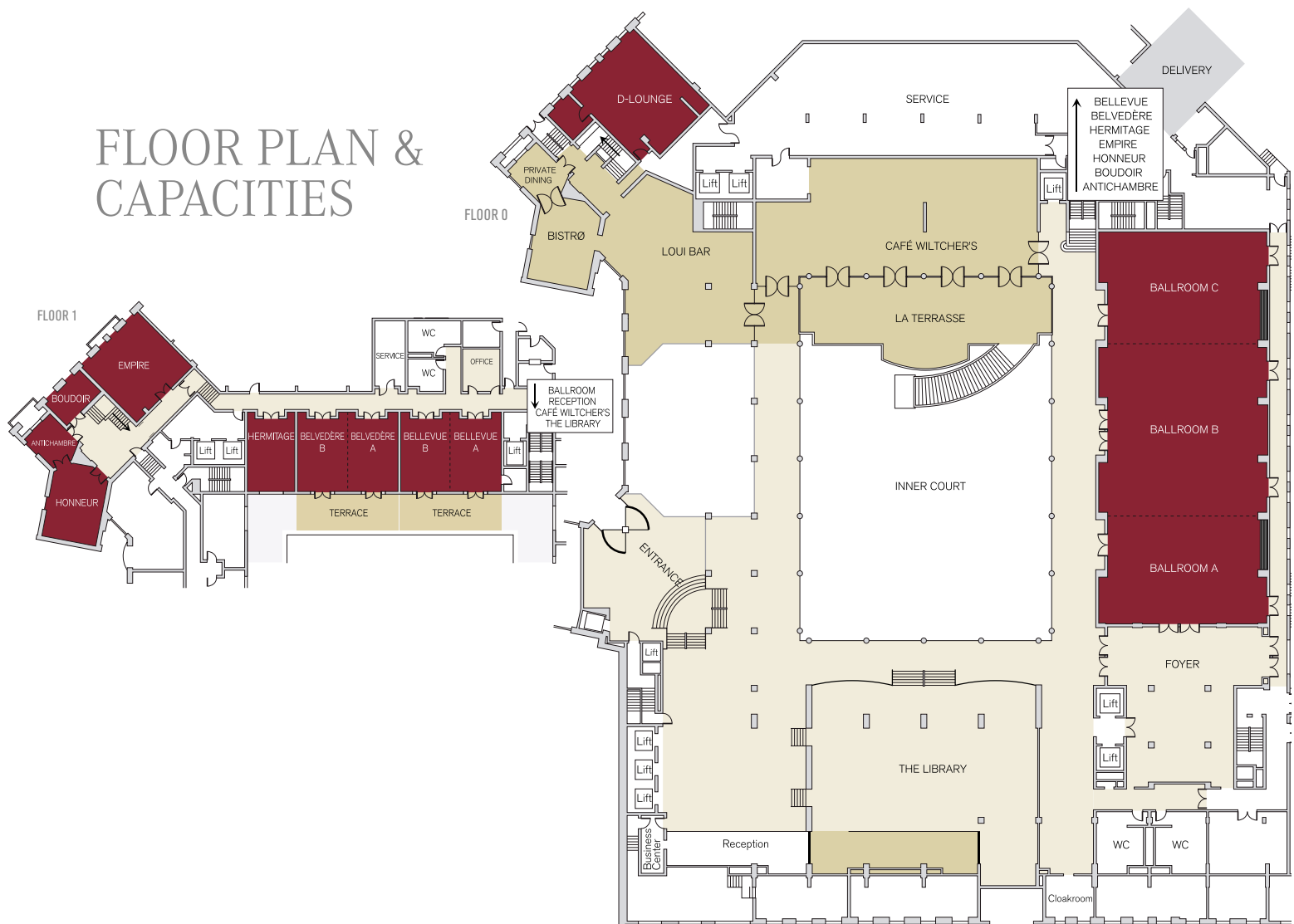

MEETINGS AND EVENTS

In this city of international gatherings par excellence, the Steigenberger Wiltcher's does more than hold its own. Its ballroom, the city's largest, can seat up to 600 people – ideal for a product launch or gala evening. Ten function rooms, spacious suites and a terrace that can be privatised, providing an endless range of possibilities, completed with high-end hotel and catering services.



STEIGENBERGER WILTCHER'S

71, Avenue Louise · 1050 Brussels, Belgium
T +32 2 542 42 42 · F +32 2 542 42 00
brussels@steigenberger.com · www.wiltchers.com
www.steigenberger.com